

CLIPSAL[®]

by Schneider Electric

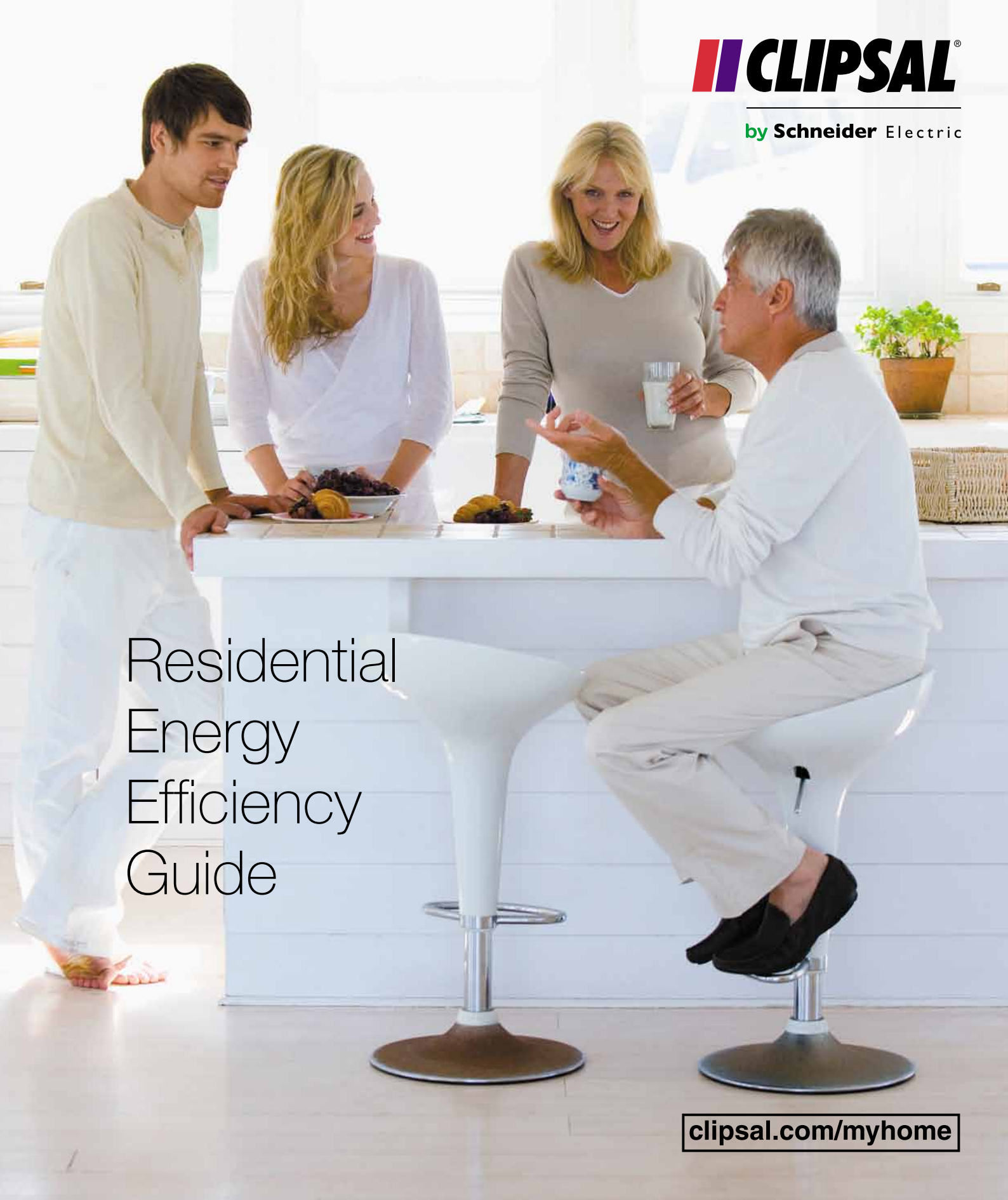

Residential
Energy
Efficiency
Guide

clipsal.com/myhome



clipsal.com/myhome
1300 878 878

Any switch can light a room, but ours can **make the future brighter**

As the number one manufacturer of electrical accessories in Australia, and as a member of the Schneider Electric family – the world leader in electrical accessories, we at Clipsal Australia recognise the responsibility that we have in coupling good business with good environmental outcomes.

Caring for the environment and the pursuit of sustainability has always been good business practice. With environmental issues now more topical than ever before, Clipsal has worked hard in recent times to successfully maintain and improve our high environmental standards as our business continues to grow. We have invested a great deal in planning, training, communication and continuously identifying areas in which we can reduce, control and eliminate environmental risks. Add to this our commitment to environmentally friendly product design and our ISO 14001 certification and it's easy to see that we're not just talking like a leader, but we're acting like one.

This guide is a great place to start. It features many innovative ideas and tips that can deliver genuine savings and convenience for your home. There is also our nationwide network of Clipsal energy electrical contractors. These experts can visit your home and provide you with a full energy and safety audit, a "home health check" to highlight those areas where you can make the most savings and ensure your home is protected from potential electrical and fire hazards.

We've helped Australian companies and businesses to make their buildings more energy efficient and safer. Now we're helping you. In saving energy you're also doing your bit to save the environment. 95% of Clipsal products are manufactured from halogen and PVC free material, and in the near future, it will be 100%. Even our packaging and brochures are printed on 65% recycled paper.

I thank you for taking the time to consider our many solutions. I wish you well in the choices you make for your home and hope that you will enjoy significant energy savings and the reassurance of a safe electrical system.

Damien Cummins,
Executive General Manager, Clipsal Australia Pty Ltd

You can do something about your home's rising energy costs just by making a few small changes, without sacrificing your lifestyle.





Your guide to **using electricity** more **efficiently**

Australia's appetite for a comfortable lifestyle through the use of technology is one of the greatest in the world. Today's homes feature powerful air-conditioning systems, entertainment centres, networked computers and modern appliances in the kitchen. And while we enjoy the benefits of technology, our energy costs have increased. With energy costs set to double in the future, households are demanding solutions to reduce their energy consumption and costs, without sacrificing comfort and lifestyle.

Clipsal is Australia's leading electrical company with over 90 years experience. We have a long history of pioneering energy efficient products for the home, from the famous Infrascan that automatically turns lights on and off, through to our C-Bus home automation systems, designed to provide comfort, convenience, safety and security as well as real energy savings.

It is of no surprise that Clipsal is once again at the forefront of energy efficiency, with the introduction of our Home Energy & Safety Audit. This innovative program is designed to make your home safer, more energy efficient and save you money on electrical bills, all while allowing you to maintain your lifestyle.

Clipsal's Home Energy & Safety Audit

With the introduction of our Home Energy & Safety Audit, Clipsal is highlighting the need to provide real solutions for a very real problem. Delivered through our national network of licensed electrical contractors, the audit involves a single visit to your home. The certified energy electrician performs a complete energy 'health check' and electrical safety inspection. A full energy report is developed and from the results you can see exactly where energy is being consumed in your home. In the report we prescribe ways to optimise energy usage and also where you can upgrade or modify to achieve additional energy and cost savings. Having a licensed electrical contractor visit also has additional benefits, the safety check provides real peace of mind and if any work needs to be performed a quote for work can be provided with your report.

Clipsal Australia Pty Ltd reserves the right to change specifications, modify designs and discontinue items without incurring obligation and whilst every effort is made to ensure that descriptions, specifications and other information in this catalogue are correct, no warranty is given in respect thereof and the company shall not be liable for any error therein.

For the **ultimate**
web **experience**
visit **clipsal.com/myhome**

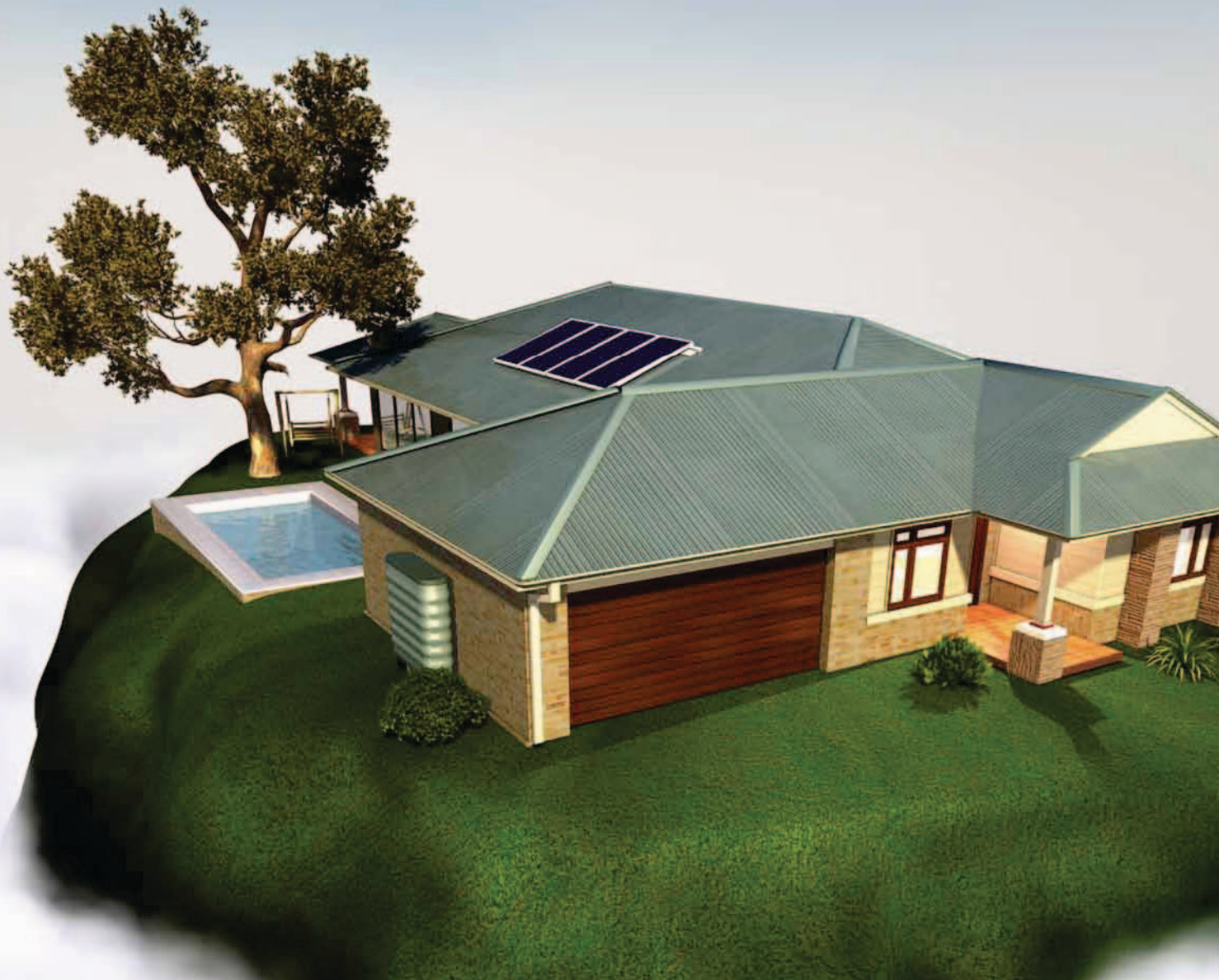

Hold the marker upright towards the camera to activate your augmented reality experience.

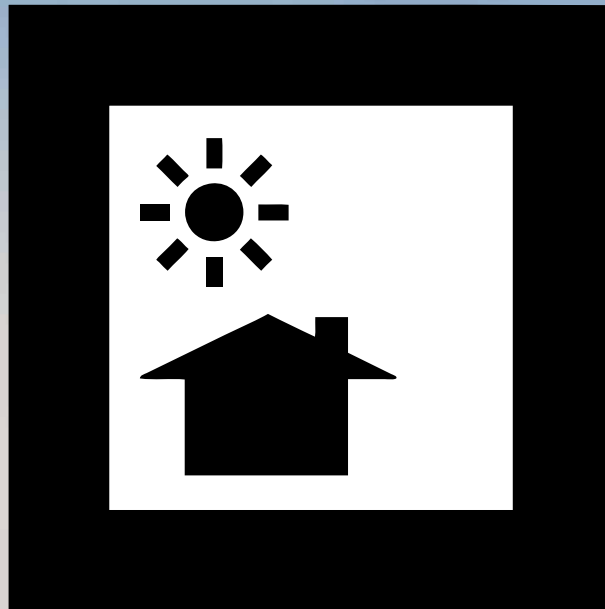

Instructions:

- Make sure your webcam is on.
- Visit clipsal.com/myhome and click Explore the Clipsal House.
- Hold the house glyph in front of your webcam.

For best results:

- Avoid getting glare on the house glyph.
- Use two hands if lifting the house glyph in the air.
- Create a flat surface for the house glyph by placing a book underneath.

Your Energy Solutions for Life

Contents

1. Home Energy & Safety Audit	12
2. Renewable Energy	14
Clipsal Solar	16
3. Energy Management	18
Measuring Energy Use	20
4. Lighting Strategies	22
Indoor Lighting	24
Dimmers	26
Infrascans	28
Sunset Switches	30
Timers	32
5. Tactics for Cooling & Heating	34
Ceiling Sweep Fans	36
Exhaust Fans	38
Bathroom Fan/Light/Heater	40
6. Water Strategies	42
Pool & Spa Strategies	44
7. Eliminating Standby Power	46
Standby Power	48
8. Home Safety Solutions	50
RCD Protection	52
Surge Arrestors	54
Smoke Alarms	56
Additional Home Safety	58
9. Colour & Finish	60

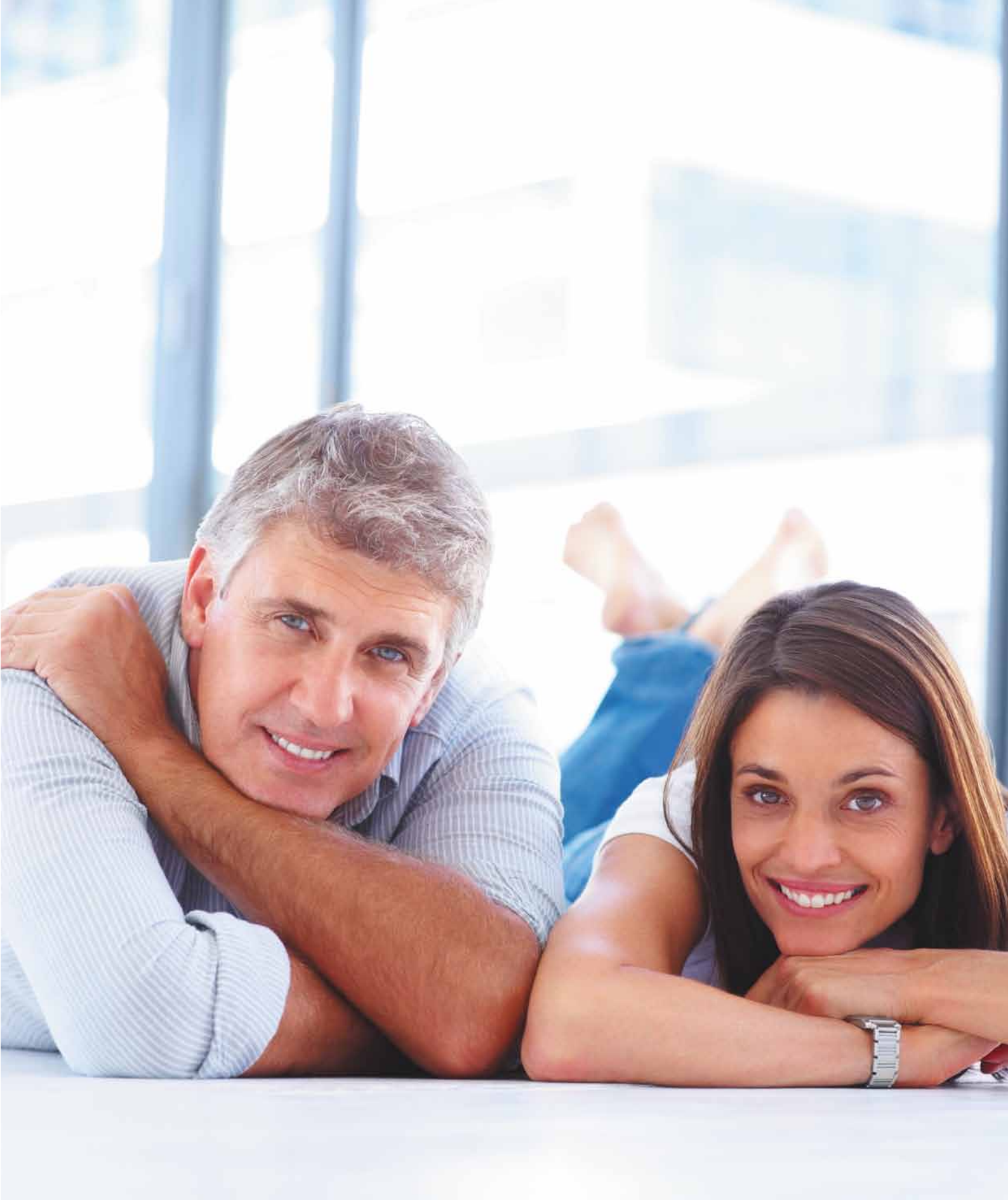

Energy Solutions for every home





Home

Energy & Safety Audit

Expert advice for an energy efficient & safe home

Just like servicing your car, your home needs to be monitored and serviced too. Your home's electrical system needs to be checked by a qualified electrician to ensure it's operating safely to protect your investment, and more importantly protect your family from fire and electrical hazards.

That's where our Clipsal certified energy electricians can help, with a comprehensive Home Energy & Safety Audit. They can advise you on opportunities for energy savings as well as supply and install energy saving solutions in your home.

Clipsal certified energy electricians can:

- advise and design the best solar energy solution for your home
- advise you on energy saving opportunities in your home, such as the installation of low energy lighting, motion sensors, timer switches and ceiling sweep fans to reduce energy use
- provide you with an estimation of energy savings from the onset
- inspect and test residual current devices (Safety Switches), surge arrestors and circuit protection for correct operation, to provide greater safety from electrical hazards
- inspect and test electrical and fire safety of insulation material fitted in the ceiling
- inspect and test smoke alarms in your home
- inspect switches and power outlets inside and outside your home.

Not only will you gain control of your energy use and save money, but you'll also improve the safety of your home's electrical system, which may one day save a life.

Smoke alarms
must be **replaced**
every 10 years

to keep your
family and
property safe

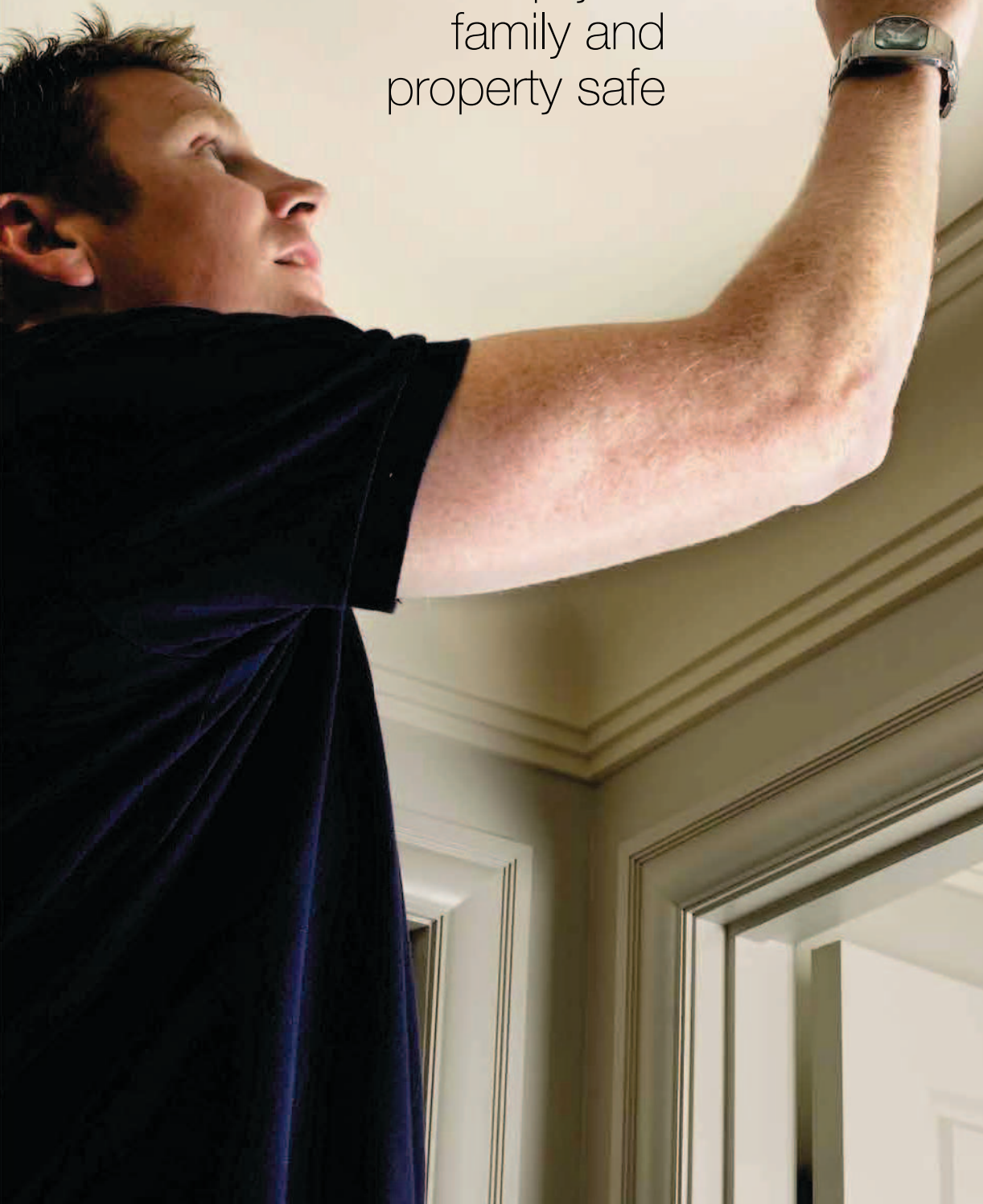



It pays to be **green**

Renewable Energy

An ever-increasing demand for power will put more and more pressure on our electricity supply. Worse still, our aging grid is incredibly inefficient, with only a third of power generated actually reaching its destination. These factors will force the price of power up exponentially, with high tariffs being imposed at peak times to encourage you to better manage your consumption. So how can we use renewable energy to reduce our reliance on the grid and cope with these increased costs?

Renewable energy is an excellent way to make your home environmentally friendly. It not only saves our limited natural resources, but also saves you money. Australia's sunny climate is perfect for enjoying the many benefits of solar power.

Using renewable energy, you can enjoy the benefit of:

- reducing your energy costs
- knowing you're helping to reduce your carbon footprint
- feed-in tariffs from the utility companies
- minimising the impact of future energy cost increases.



Clipsal Solar

Reduce your energy costs and save money

With generous government rebates on solar systems, rising energy costs and the falling cost of solar technology, a Clipsal Solar solution makes economic sense.

A Clipsal Solar solution is a solid investment that pays for itself in a very short period of time. Not only will Clipsal Solar Solution provide you with free electricity for decades to come, but also add value to your property, slash your energy bills and reduce greenhouse gas emissions.

* Based on the estimation of the average household consuming 6,840kWh p.a. (Energy use in the Australian Residential Sector report, Department of Climate Change, 2008.)

** Tonnes of greenhouse gases saved; calculated at approximate rate of 1kg CO₂-e/kWh as per Department of Climate Change, National Greenhouse Accounts (NGA) factors, June 2009 - full fuel cycle emission factors for grid purchased electricity for Australia.



Our solar solutions

Clipsal Solar solutions range from 1.44kW to 5.04kW systems, and are suitable for all residential applications. A 1.5kW solar system is capable of reducing electricity costs by up to 30%* and reduce greenhouse gas emissions by 2,050kgs per annum**. While in most cases, a 5kW system makes your home self sufficient of electricity energy needs.

- Solar energy solutions ranging from 1.44kW to 5.04kW.
- 25-year performance warranty on solar panels.
- 5-year parts and labour warranty on solar inverters.
- Solar panels designed in the USA.
- Solar inverters designed in Canada.
- Mechanical brackets suitable for tiled and sheet metal roofs.
- Professional grade circuit protection equipment.
- Installed by CEC accredited electrical contractors.
- Adds capital value to your home.

Energy efficiency benefits

- A 1.5kW solar system can reduce your electricity energy costs by 30%, whilst a 5kW solar system can deliver an energy solution to make the average home self sufficient.
- A 1.5kW solar system can reduce greenhouse gas emissions by approximately 2,050kgs per annum.
- Feed excess energy back into the grid to reduce your energy costs even further.
- Helps protect your home against future energy price increases.

Solar core products

- Clipsal Solar Solutions range in capacity from 1.44kW to 5.04kW, systems designed to deliver free energy and cost savings for 25 years and beyond.



Free energy
and **cost savings**
for a lifetime

A woman with long blonde hair is sitting up in bed, resting her head on her hand. She is looking at a utility bill she is holding. The bill features a line graph showing energy usage over time. The room is brightly lit, and a wooden beam is visible on the ceiling.

Measure your
energy use and
stay in **control**

Energy Management

Measure, control, monitor and save

Understanding the cost of your electricity is the first step towards reducing an electricity bill. By monitoring energy use, you can better control how energy is used in your home.

The concept is simple:

- Understand how much energy is being used and where.
- Identify opportunities where you can take immediate action to reduce your energy consumption.
- Implement solutions.
- Sit back and enjoy the savings on your energy bills.



Measuring Energy Use

Measure home energy use and stay in control

Clipsal's Energy Consumption Monitor has a large LCD display that makes it easy to keep an eye on your running costs and energy consumption. It also displays greenhouse gas emissions, temperature, time and date, which assist you to stay in control and decide how energy is used.

In addition, it features a programmable alarm that beeps when your peak power limit is reached. And for even greater insight into your energy consumption, you can compare usage daily, weekly, monthly and yearly.

Clipsal energy management solutions

- Wireless electricity monitor that displays your energy use and cost on a portable, easy to read LCD monitor inside your home.
- Simple to use.
- Displays temperature and humidity to show comfort levels inside your home.
- Alarm notification when peak power limit is reached.
- User set tariff rates.
- Able to measure and display energy from solar system.

Energy efficiency benefits

You can save up to 10% of your electricity consumption by understanding how energy is used in your home. This enables you to modify your behaviour and achieve energy and cost savings.



Save up to
10%
energy

A long, narrow hallway with a light-colored floor and white walls. The ceiling is white with several recessed circular lights. The walls are also white, with several recessed rectangular lights. On the right side, there is a decorative wall with a vertical wood-grain pattern and a built-in shelf holding a vase with flowers. At the end of the hallway, there is a view into a kitchen with a window, a table with chairs, and a refrigerator. The overall lighting is warm and modern.

Shedding **light**
on **energy savings**

Lighting Strategies

Know your lighting

Lighting plays a very important part in your house design, comfort and ongoing energy costs. Correct lighting needs to be chosen to suit the application within your home. Clipsal offers a comprehensive lighting range and advice on the correct use of different lamp types to create genuine energy savings.

Linear and fluorescent lighting

Compact fluorescent lamps or CFLs are low energy, long life lamps. They are ideal for areas that require lighting for long periods and are infrequently switched, such as outside lighting, kitchens, studies and living areas. Fluorescent lamps provide an excellent light output and are a great choice for general lighting within your home.

Halogen lighting

Modern halogen IRC lamps are 30% more energy efficient than their predecessor with the same light output and long lamp life. Halogen lamps are dimmable and a great option to create mood lighting. They're ideal for living areas, bedrooms, home theatres and dining rooms. Halogen lighting produces a warm comfortable light with a sparkle effect not found with other lighting types.

LED lighting

LED lighting is the most energy efficient and longest lasting lighting product on the market today. LED lighting is ideal for accent lighting in cabinets, under kitchen benches, pathways, wall lights and staircases. They're also a great energy saving option for bedrooms, living rooms, home theatres and dining rooms. And in most cases, they can replace halogen lighting in these applications.



Indoor Lighting

Energy and cost savings

Downlights are the most popular lighting choice and can be found in the latest modern homes, or in extensions and refurbishments of older style homes.

Clipsal downlights are available in a wide range of colours, styles and configurations, including gimble versions to suit any and every indoor application. Today's downlights are available with halogen, compact fluorescent and LED technology lamps incorporated.

IRC halogen lamps are the latest halogen technology lamps. A 35W IRC halogen lamp creates the same light output as a standard 50W halogen lamp, while using 30% less energy in the process. IRC halogen lamps are dimmable and last twice as long as standard halogen lamps.

Compact Fluorescent Lamp (CFL) down lights are long life lamps, and have a lifetime of between two and five times longer than halogen lamps. CFLs also use much less energy than incandescent lamps, and up to 80% less energy in most cases. Some CFL lamps are dimmable, but special CFL dimmers are required.

LED lamps are the most modern type of lighting and use a similar amount of energy as the down light style CFL for the same light output. An advantage of LED lamps is their lifetime. They can outlast halogen lamps by up to ten times and CFLs by four times. LED lamps are dimmable and have similar light output as a standard 50W halogen or 35W IRC halogen.

Clipsal lighting solutions

- Wide range of downlight styles with halogen, CFL and LED lamp technologies.
- Compatible with Clipsal C-Thru range of dimmer products.
- Lifetime of downlights can be extended when used in conjunction with Clipsal C-Thru dimmers.
- Saving of between 30% and 80% of energy when compared with incandescent lamps for similar applications.
- 35W IRC and LED down lights are a direct replacement for 50W halogen lamps, in most situations.
- Use of Clipsal dimmers saves energy.

Energy efficiency core products

Clipsal's extensive lighting range offers an energy efficient lighting solution to suit your requirements.

Savings of between
30% and **80%** of
lighting energy costs





Dimmers

A simple solution to save you energy

Dimmers don't just set the mood, but they can save money too. Most of the time we don't need to set our lights to full brightness to light a room, and if you dim your lights you're using less energy to run them. Clipsal leads the way in dimming technology and manufactures dimmers for all lamp types. So if you want to control a single lamp or string of lamps we have a dimmer to suit.

Clipsal dimmers are available in a wide range of styles and finishes with push button, rotary or remote control dimmer functions. There's sure to be a dimmer to suit all your requirements.

Clipsal dimming solutions

- A wide range of dimmer technology products, which are compatible with the majority of lamps.
- Remote control versions available.
- Power range of dimmers from 300W to 2000W.
- Short circuit protection and thermal overload protection on most models.

Energy efficiency benefits

- Energy and cost savings are achieved when your lighting is dimmed.
- Dimmer units extend the lifetime of your lamps so they need to be replaced less frequently.
- Dimmer units are used to set the desired light level, which reduces energy consumption.
- Energy savings between 10% and 50% can be achieved.

Energy efficiency core products

The Clipsal IR Dimmer represents the next generation of smart dimming products.



Dim your
lights and
save up to
50%
energy



Infrascans

Safety, convenience and energy savings in one

The original Infrascan was developed by Clipsal, and remains a popular choice due to its reliability, ruggedness, and simplicity of operation, while also offering a five-year warranty. The Infrascan is designed to conveniently turn lights on automatically when movement is detected, and turn off after a pre-set period of time.

Indoor Infrascans are suitable for open plan areas, single rooms, offices, laundries, toilets, walk-in robes, hallways and pantries.

The outdoor Infrascan will operate under all weather conditions and features long-range detection with immunity to false triggering. Infrascans can be used for garages, driveways, porches and outdoor living areas. They also provide you with peace of mind by automatically lighting up an area to deter intruders and trespassers. However you look at it, Infrascans offer enhanced security, convenience and energy savings.

Clipsal Infrascan solutions

- A wide range of Infrascan products for indoor and outdoor applications.
- Outdoor models are suitable for all weather conditions.
- Available in 90, 110 and 360 degree detection.
- Long range detection capability and immune to false triggering.
- Surface and flush mount models available.
- Available with integrated lights in outdoor models.
- Override control for manual operation.
- 5-year warranty.

Energy efficiency benefits

- Energy and cost savings are achieved when lighting is switched on only when required.
- Remembers to turn load off, even when you don't.
- Enhanced convenience, safety and security.
- Energy savings between 30% and 50% can be achieved.

Energy efficiency core products

An extensive range of indoor and outdoor models to suit any application.



Switch off
unused lighting **and save**
up to 50% energy



Sunset Switches

See the light in saving energy

Sunset Switches use a light sensor to switch lights on once daylight levels drop below the desired level, and switch lights off once again at sunrise. The best thing is Sunset Switches automatically adjust to seasonal changes. They're even available with inbuilt timers so you can programme the lights to turn off after a set time. Clipsal Sunset Switches are perfect for entrance areas, pathways, garden and car park applications — lighting the way for a safe welcome home and to deter would be intruders.

Clipsal Sunset Switch solutions

- Suitable for all weather applications.
- Available as dusk to dawn models or with programmable time delay.

Energy efficiency benefits

- No wasteful energy or additional cost due to seasonal changes.
- Programmable time delay means lights are on only for the period required.
- Enhanced convenience, safety and security.
- Achieve energy savings up to 20%.

Energy efficiency core products

If you require dusk to dawn lighting, Clipsal Sunset Switches are your energy efficient option.



Save
up to
20%
energy



Timers

It's time to save energy

Another great way to save energy is to have a timer do the work for you. Timers are particularly useful in areas where you need lights, fans or heaters to operate for a short period of time and turn off automatically.

Timers are ideal for exhaust fans in toilets and bathrooms, lights in pantries and walk in wardrobes, or towel heaters in bathrooms. Simply set the timer, and it will remember to turn itself off.

Clipsal timer solutions

- Available as electronic or pneumatic switches.
- Programmable time delay, from one minute to 15 hours.
- Status countdown LED indicator on some models.

Energy efficiency benefits

- Precise time control saves energy and costs.
- Programmable time delay results in wide applications for timer switches.
- Enhanced convenience, safety and security.
- Achieve energy savings between 20% and 30%.

Energy efficiency core products

Set and forget switches that provide exact time control of lights, fans, heaters or other devices.



Switching devices
off automatically
can **save**
up to 30%
energy



Stay
comfortable

Tactics for **Cooling & Heating**

Save energy and stay comfortable

There is nothing like a cool fresh breeze throughout your home. Not only is it comforting, but it also helps to freshen the air.

Ceiling sweep fans are fashionable, super quiet and an effective way to freshen the air and cool your home, while saving energy and reducing air-conditioning costs.

The convenience and comfort of warming up efficiently in winter comes at a price - energy consumption and cost. Choosing the right types of heating and air circulation, and implementing effective insulation measures can all assist in minimising your excess energy costs.



Ceiling Sweep Fans

Natural and efficient

Ceiling sweep fans are an effective natural way to cool your home or circulate heat. In most cases, when the outdoor temperature is less than 30 degrees, a ceiling sweep fan is all you need to stay cool and comfortable. Stylish in design with remote control options and inbuilt lighting, ceiling sweep fans are super quiet and use less energy than a standard light bulb.

Ceiling sweep fans are just as practical in winter, whereby reversing the airflow will circulate warm air that accumulates near the ceiling. This increases the efficiency of the heating and reduces your energy costs at the same time.

Clipsal ceiling sweep fan solutions

- A wide range of three, four and five-blade ceiling sweep fans.
- Available in remote control or wall control versions.
- Stainless steel and powder coat finishes.
- Forward and reverse air flow capability.
- Three stage or variable fan speed controllers.
- Suitable for indoor and outdoor use.
- Reliable and quiet motors.

Energy efficiency benefits

- Typical savings of \$126 in energy costs per annum.
- Cost effective way to cool a home day and night.
- Uses substantially less energy than air-conditioning units and systems.
- Improves effectiveness of heating, pushing down warm air from the ceiling.

Energy efficiency core products

Save on heating and cooling costs with Clipsal's ceiling sweep fans.

Save up to
\$126 in energy
costs per annum





Exhaust Fans

Keep the draught out

Studies have shown that poor seals around doors and windows, and air leaks elsewhere account for up to 15% of heating and cooling loss in the home. Exhaust fans commonly found in kitchens, bathrooms, laundries and toilets are used to exhaust stale air to the outside or into the roof space. Most exhaust fans are open at the back and allow warm air to escape in winter and hot air to enter in summer. Clipsal exhaust fans are fitted with new backdraft shutters that close automatically when the exhaust fan is not in use, thus preventing air entering or escaping into the home.

Clipsal exhaust fan solutions

- Clipsal exhaust fans feature a backdraft shutter that closes automatically when not in use.
- Unique grille design reduces dust collection by 80% and requires cleaning less frequently.
- Designed to move a large volume of air - equivalent to 290m³ per hour.
- High performance centrifugal fan.
- Side entry duct connection.

Energy efficiency benefits

- Save up to \$72 in energy costs per annum by sealing openings for the average home.
- Minimises heating and cooling costs.
- Prevents hot air from entering the home in summer and warm air escaping in winter.

Energy efficiency core products

Exhaust fans remove steam from bathrooms and stale air from the home, while offering the energy saving benefits of Clipsal's unique backdraft shutter designs.

Save up to
\$72 in energy
costs per annum by
sealing openings
throughout the home





Bathroom **Fan/Light/Heater**

Warm up efficiently

The Clipsal Sunshine range of fan, light and heater combination units offer an ideal solution for your bathroom, where instant warmth and maximum comfort are a must.

To optimise energy use and tailor the temperature to your individual requirements, the Sunshine range allows you to select the heat output, only using the energy that is needed.

For added convenience, a powerful exhaust fan is incorporated into the unit. And for those applications where only lighting is required, Clipsal provides a low energy, long life fluorescent lamp.

Clipsal fan/light/heater solutions

- Efficient and economical operation.
- Multiple choices – two heat lamp model for use in ensuites, and four heat lamp model for main bathrooms.
- Some models feature flexible ducting option.
- Efficient ball bearing motor and centrifugal fan for optimum ducting performance.
- Built-in thermal protection - temperature sensor automatically turns off heat lamps if overheating is detected. Exhaust fan and centre light continue to operate, on selected models.

Energy efficiency benefits

- Supplied with energy efficient compact fluorescent globe.
- User selectable heat settings.
- Some models feature backdraft shutters to reduce air draughts.

Energy efficiency core products

Turn your bathroom into an oasis of warmth and light with Clipsal fan/light/heaters, with the energy efficient option of heat control and backdraft shutters.



User selectable
heat settings
 can lead to
energy savings
 of up to **50%**
 or more



Simple solutions
to **save energy**

Water Strategies

Save electricity, use a timer

Water saving is front of mind for every Australian. Water saving strategies and devices such as flow-regulators, taps, dual-flush toilets, sensors and timers are becoming more common. There are also some simple things you can do around the home to reduce the consumption of energy in relation to water features, ponds, pools and spas. Typically exposed to the outdoors, the Clipsal weatherproof timer and industrial range can assist you in managing electrical consumption by enabling you to set up a more efficient operating regime.



Pool & Spa Strategies

Timer switches

If you own a swimming pool or spa, a Clipsal timer switch is the ideal solution to reduce your energy costs. It can be programmed for the seasons, which means your pool pump operates for longer periods during the summer months when the pool is in use, while in winter the pump will operate less frequently when the pool isn't being used.

The recommended ranges for summer and winter pool filter operation are eight and four hours respectively. In most cases a reduction in running time per day will provide instant savings, however drastic reductions may result in under-filtering and associated chemical requirements would defeat the purpose of the energy saving. We recommend you make changes in consultation with your local pool service technician.

Clipsal timer switch solutions

- Clipsal manufacture a range of time clocks for pool pump applications.
- Suitable outdoor applications.
- Simple to program and use.
- Support multiple schedule programs.

Energy efficiency benefits

- Seasonal schedule control of pool pumps can save over \$525 per annum in energy costs.
- Operating pool pumps less frequently may increase service life.

Energy efficiency core products

A programmable timer can operate your pool pump according to seasons and provide you with substantial energy savings.



Seasonal schedule
control of pool pumps
can **save over**
\$525 per annum
in energy costs

A man with short brown hair, wearing a dark blue or black button-down shirt, is shown in profile from the back, looking towards a large, dark screen. He is holding a smartphone in his right hand, which is raised towards the screen. The background is a warm, orange-brown wall. The text "Avoid paying money for nothing" is overlaid on the right side of the image.

Avoid paying
**money for
nothing**

Eliminating **Standby** Power

A study by the United Nations Economic and Social Commission for Asia and the Pacific, estimated that the average Australian household uses 86.8W of standby power at any time. This is equivalent to 760kWh per annum or 11.6% of the total energy consumption in the home.

Standby power creates over four million tonnes of greenhouse gases in Australia every year and is set to double every nine years as we incorporate more electronics into our homes in the future.



Standby Power

Money for nothing

Standby power is that small amount of power appliances such as televisions, DVD players, phone chargers and microwave ovens consume when sitting idle. Standby power otherwise serves no useful purpose, which means you are paying money for nothing. It is of no surprise to learn that over 10% of your home's electricity costs can be the result of standby power.

You can minimise or totally eliminate standby power costs by simply switching off power at the outlet. Clipsal offers a range of innovative products to help you do this, such as remote kill switches and intelligent plug packs that automatically senses the device is in standby power and switches it off.

Clipsal standby power solutions

- Remote control kill switches turn off devices when not in use.
- Simple to use.
- Cost effective.

Energy efficiency benefits

Remote control kill switches can reduce total power energy consumption by up to 10%.

Energy efficiency core products

Remote kill switches and intelligent plug packs sense a device is in standby power and automatically switch it off, helping to reduce your energy consumption.



Kill switches
can help you **save**
up to 10%
energy **consumption**
by reducing standby power

A photograph of a bedroom at night. In the foreground, a white smoke alarm is mounted on the ceiling. Below it, a person is sleeping in a bed with a tufted headboard. The room is dimly lit, with a framed picture on the wall and a bedside table visible. The text is overlaid on the left side of the image.

The Clipsal range of **smoke alarms** and **Safety Switches** are proven **lifesavers**

Home **Safety** Solutions

Protect your home and family

Clipsal's comprehensive range of safety products are designed to make your home safer and help protect your family from electrical hazards. The Clipsal range of smoke alarms and Safety Switches and RCD protected devices are proven lifesavers and a must in all homes.

Our fast acting circuit protection equipment guards against electrical faults and reduces the possibility of electrical fires, while our high capacity surge arrestors are designed to protect your expensive electronic equipment from lightning strikes and electrical network faults.



RCD Protection

Lifesaver® Safety Switches

Clipsal is recognised as a leader in the field of electrical accessories and has over 90 years experience. Clipsal manufacture a wide range of RCD switches and Lifesaver Safety Switches that meet and exceed Australian standards.

Give yourself peace of mind with the simple installation of a Clipsal Lifesaver Safety Switch in your home's electrical switchboard. Your family will have the best protection money can buy.

How to avoid the tragedy of electrocution

The Clipsal Lifesaver Safety Switch works by continually monitoring the current flow. In the case of a faulty appliance or live wiring, the current balance is disturbed and the RCD automatically reacts and disconnects power, protecting against electrical shock and preventing loss of life.

Protection for the entire home

Clipsal offers switchboard, power outlet and portable RCD protected outlets. Mounted in the electrical switchboard, Clipsal Safety Switches protect the power and lighting circuits in your home. They should also be fitted in workshops and garages to provide additional protection. Clipsal's Safety Switch offers comprehensive protection and is your first line of defence.



**Safety Switch
Whole Home
Protection**

Single circuit protection

The Clipsal Lifesaver Power Outlets feature an inbuilt RCD. They're designed to provide protection to you and your family and are ideal for nurseries, workshops, kitchens, bathrooms, laundries and any other wet areas.



**Protected
Power
Outlets**

Portable protection

If you're a tradesperson or a home handyman who works away from fixed RCD protection, portable protection is a must. The cords of power tools and electrical garden equipment are easily damaged, and using any appliance in damp conditions can also be dangerous.

The Clipsal Lifesaver range of portable protection includes plugs, plug adaptors, heavy-duty cord sets and cable reels, which offer you safety when working with electricity.



**Portable
Protection for
Workshops**

Thermal protection power outlets

The Thermal Trip power outlet is an innovative design that comes loaded with benefits. Designed to shut down power to a device if overheating is detected, it protects wiring, prevents fires from starting and avoids any further damage to the device if there is a fault or problem. It's also easy to reset from the power outlet, so you don't have to go to the mains switchboard.



**Thermal
Protected
Power
Outlets**



Surge Arrestors

Protection from surges

Lightning strikes, mains electrical faults and even branches falling onto power lines during a storm can cause surges. Surges are voltage spikes measuring several thousands of volts that travel down the power lines, through the electrical switchboard and into customers' electronic equipment. This can affect electronic devices such as large screen televisions, computers, alarm systems, washers and dryers. The result can cause catastrophic failure or permanent damage to equipment.

A switchboard surge arrestor is designed to stop surges into the switchboard and prevent them entering your home. The surge arrestor is a small investment and the best way to protect your assets and property.

Clipsal surge arrestor solutions

- Clipsal has a wide range of lightning and overvoltage protection equipment for electrical switchboards, power outlets and portable devices.
- Switchboard mounted overcurrent devices are designed to protect your equipment from lightning strikes.
- Switchboard mounted surge arrestors are designed to protect your equipment from overvoltage conditions.
- Surge arrestor modules may be removed and replaced by an electrician when they fail.
- Switchboard mounted surge arrestors can be connected to an external buzzer or light.

Surge protection benefits

- Protects electronic equipment that may not be covered by insurance, from permanent damage.
- Helps to prevent electronic stress on your equipment, which may reduce performance over time.
- Low cost to have installed by an electrician.
- Switchboard mounted surge arrestors protect all your electronic equipment.
- Surge protected power outlets offer protection of equipment from the outlet.

Surge protection core products

Surge arrestors protect your property and assets from damaging electrical surges.



Clipsal's surge arrestors
are a **small investment**
and a **first line**
of defence
from electrical damage



Smoke Alarms

Smoke alarms save lives

Smoke alarms save lives and protect property from the powerful destruction of fire. Smoke alarms have a limited working life and need to be replaced every 10 years to provide adequate protection for your home and family.

Clipsal offers a complete range of ionisation and photoelectric smoke alarms to suit all applications. The range includes surface mount units and a low profile flush mount design, which is ideal if you're seeking a smoke alarm to be as unobtrusive as possible.

Specifically designed for early smoke detection and superior protection, our range of smoke alarms fully meet Australian standards for performance and features. In addition, Clipsal smoke alarms are compatible with all makes on the market, so replacement is easy, with no new wiring or holes in the ceiling required.

Clipsal smoke alarm solutions

- Clipsal manufacture a wide range of ionisation and photoelectric smoke alarms.
- 240V a.c. operation with 9V d.c. battery backup.
- Surface and flush mount units available.
- Test and hush button.
- Loud audible alarm output.
- Meets Australian Standard AS3786.

Smoke alarm benefits

- Smoke alarms are designed to protect your family and home from the destruction of fire and smoke.

Smoke alarm core products

Smoke alarms alert occupants of dangerous smoke or fire.

Smoke alarms
save lives
and protect property





Additional Home **Safety**

Clipsal Awesome Foursome

The use of portable power boards and plug adapters have seen widespread adoption as we embrace technology and find more and more equipment to plug in. The tangle of wires represents potential fire or electrical safety hazards because plug adapters may come loose, expose live pins and cause a risk to small children.



**No More
Cable
Tangles**

The solution is to update the old single and double power outlets with Clipsal's Awesome Foursome power outlet. The Clipsal Awesome Foursome eliminates the tangle of cables and removes any potential electrical hazard.

Weatherproof - Indoors

Electricity and water don't mix. How many of us have switched on a light with wet hands in the kitchen, laundry or bathroom? For added safety, Clipsal has developed a range of waterproof switches for indoor applications. These switches feature a special rubber membrane barrier to prevent water entering the switch, but they look like any other switch from the front.



Ideal in Bathrooms and Laundries

Weatherproof - Outdoor

Our love for outdoor living and gardening has increased the need for outdoor switches and power outlets. Clipsal have responded with a wide range of weatherproof switches designed to operate outdoors in direct weather, while offering unparalleled protection and safety. Constructed from heavy-duty plastics, Clipsal's weatherproof switches are designed to resist corrosion, colour fading and impact.

To help complement your home's design, the Clipsal range of switches are available in various colour finishes such as sandstone, brown and black to match brickwork or rendering.



Weatherproof Outdoor Switches and Sockets

Front-loading modules and safety shutters

If you're after additional safety options there are other switch and outlet solutions that will assist.

Perfect for anyone with an adventurous child, the Modena 800 Series™ includes front-loading switch modules, which are designed to combat frontal impact. Put simply the modules cannot be pushed back into the wall cavity.

Reduce any further risk by installing this range. The power outlets are internally switched and combined with safety shutters on each socket, which means that only an appliance plug will create a connection.



Safety Shutters for Added Protection

Colour & Finish

Choose the colour and finish to suit any room of your home.

Clipsal Saturn™ 250V



Pure White (PW) Ocean Mist (OM) Espresso Black (EB)

Metal Plate™ Range



Stainless Steel (BSL) Brass (BBSL) Anodised Aluminium (AA)

Slimline SC2000 Series®



White (WE) Cream (CM) Black (BK) Gold (GD) Soft Grey (SG) Desert Sand (DS)
 Chrome (CH) Brushed Aluminium (BA) Brushed Brass (BB) Chrome Shadow (3S) Brown (BR)

Modena 800 Series™



Blue (BL) Red (RD) White (WH) Black (BK) Charcoal (CC)
 Chrome (CH) Gunmetal Grey (GM) Platinum (PT) Champagne (CE)

Heritage™ Range

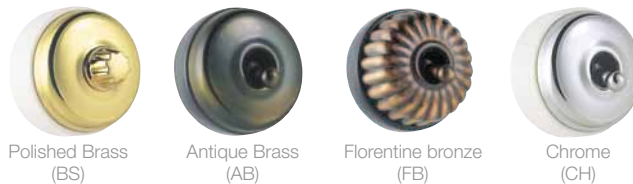

Polished Brass (BS) Antique Brass (AB) Florentine bronze (FB) Chrome (CH)

	Anodised Aluminium (AA)	Arctic Silver (3A)	Florentine Bronze (FB)	Antique Brass (AB)	Stainless Steel (SS)	Chrome (CH)	Gold (GD)	Brushed Aluminium (BA)	Brushed Brass (BB)	Polished Brass (PB)	Gunmetal Brass (GB)	Chrome Grey (GM)	Silver Plate (SP)	Gold Plate (GP)	Neo Grey (1)	Neo Silver (8)	Neo Gold (9)	White (WE)	Cream (CM)	Soft Grey (SG)	Desert Sand (DS)	Black (BK)	Brown (BF)	Red (RD)	Dove Grey (DO)	Ocean Mist (OM)	Espresso Black (EB)	Pure White (PW)	Blue (BL)	Charcoal (CC)	Platinum (PT)	Champagne (CE)	Grey (GY)		
Clipsal Saturn™																																			
Metal Plate™	*		*					*																											
Slimline®				# +	# +	# +	# +				# +																								
Eclipse®				# +	# +	# +	# +				# +																								
Impress Push Button				# +	# +	# +	# +				# +																								
Strato™						#																													
Modena™				#				#									WH						#												
Heritage™			^ ^			^					^																								
Classic C2000 Series™	~		# +	# +	# +	# +	# +	# +	# ~	# ~									+	+															
2000 Series™			#	#	#	#	#	#	#	#	#	#	#	#	#	#	#							#											
C-Bus Saturn™			-J0 -J0																																
Neo®																																			
Reflection™																																			
Lexcom Home Control																																			

+ Cover
 * Supplied with either white, black or brown grids. Available in flat (B style) or traditional (A style) thickness.
 ^ White or black porcelain bases supplied separately. Also available in smooth or ribbed finishes.
 o Neo® inner surround only.
 # Outer surround only.
 ~ Classic, Chrome Shadow™ and Arctic Silver available in quad power outlet only.
 -J0 Range specific order codes.
 PLEASE NOTE: Modena™ colour codes may vary. Please speak with your electrical contractor for more information.



PLUG INTO THE SUN

Bring sun power into your home with the **Clipsal Solar Solution**.

Fitted by a CEC certified electrical contractor along with the assurance of a warranty from one of Australia's most trusted electrical suppliers with over 90 years experience, the **Clipsal Solar Solution** offers unrivaled performance and reliability.

Now you and your family can safely and comfortably enjoy all the financial and environmental benefits of electricity free from the sun.

To find out how you can start saving today call **1300 878 878**.

clipsal.com/solar

